

ND-110324 Magtape
ND-99.119.1 EN



LOADING TAPE AUTOMATICALLY

CAUTION !

Do not open the door until the tape has stopped.
The door should always be closed when the tape
is moving.

1.
Grip the door as
shown and open
it by pulling it
towards you.

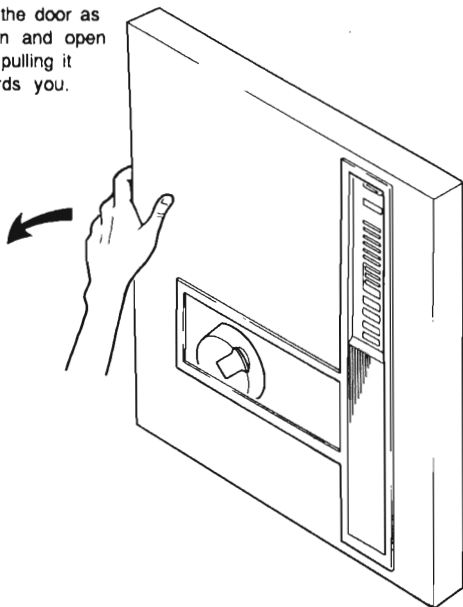

Copyright 1988 by Norsk Data A.S Version 1 8/88

Norsk Data A.S
Olaf Helsets vei 5
P.O. Box 25 - Bogerud
N-0621 Oslo 6
Norway

2. Open the reel lock.

3. Place the tape on the hub. The write enable ring (if mounted) should be on the inside.

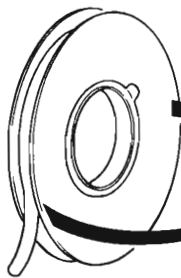

4. Close the reel lock.

5. Close the door.

6. Press the **LOAD REW** button on the operator panel. (See the other side of this card.) The vacuum blower starts.

7. Wait for the **READY** indicator to light. If **MACH CHK** is lit instead, press **RESET**, unload the tape and repeat steps 5 and 6. If it still fails, load the tape manually.

8. Choose density (BPI) by pressing the **DENSITY** key. Density 6250 gives the highest storage capacity. If you are in doubt about which density to use, contact the system supervisor.

LOADING TAPE MANUALLY

It is possible to load the tape manually if there are problems with the automatic load function.

NOTE !

When the **LOAD REW** key is pressed the vacuum blower starts and remains on for about 30 seconds. The procedure must be completed within this time. If not: close the door, press **RESET**, and repeat the procedure.

UNLOADING TAPE

1.
Press the **REW/UNLD** key.

2.
Wait for the
tape reel to
stop, then open
the door.

3.
Open the reel
lock.

4.
Remove the tape reel using
BOTH HANDS as shown.

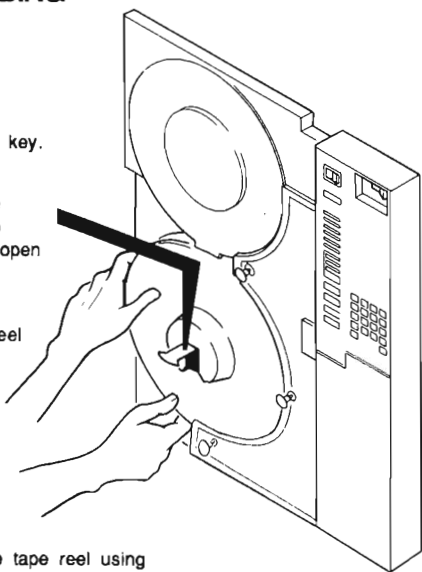

1.
Press **RESET** and press **LOAD REW** *twice*. The display
flashes **LOAD TAPE**.

2.
Open the door.

3.
Let the end of the tape hang down as shown.

4.
Turn the tape
reel as shown.
When the tape
end is caught in
the air stream,
turn the reel the
other way until
the display
flashes **SHUT
DOOR**.

5.
Shut the door.

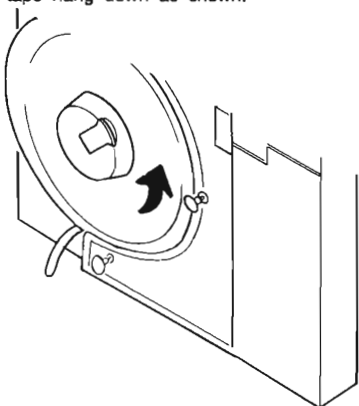

MAINTENANCE

Clean the tape path after about 8 hours use.

How to clean:

1.
Open the tape path cover by pulling the buttons indicated in the drawing below.
2.
Use a lintfree cloth moistened with cleaner fluid and clean all the places indicated in colour in the drawing to the right.
3.
Close the tape path cover properly before pushing the buttons.

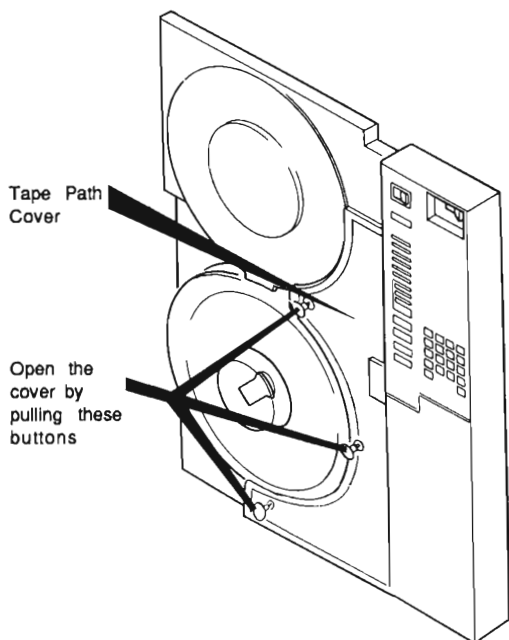

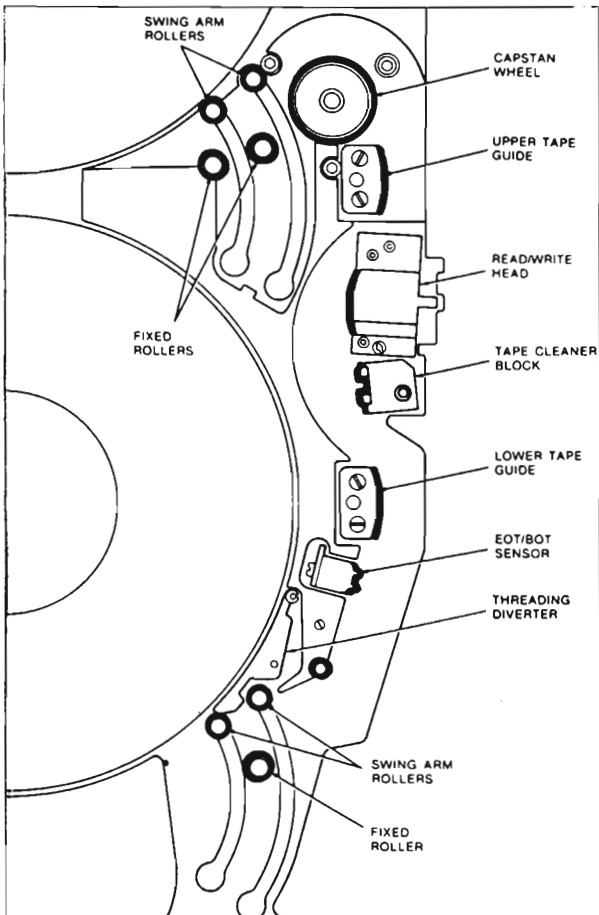

STATUS INDICATORS

Ready: lights when tape loading has been completed.

Select: lights when the tape is in online status and selected by the operator.

EOT/BOT: lights when either the EOT or the BOT mark has been detected.

On Line: lights when the online status is set and the unit is available to the user.

Machine Check: flashes to signal that the operator must check the tape loading, or that the unit requires service or maintenance.

File Protect: lights when the write enable ring at the rear of the tape reel is not detected. No write/erase operations are allowed.

System Select/6250/1600: If 1600 or 6250 is lit alone, this indicates the density in BPI for the data written to the tape. If SYS SEL is also lit, the density can be selected by software. Ref: MCOPY or Backup-system.

OPERATOR TOUCH-BUTTONS

Density select: to select the density, position the tape at the BOT mark and press this key a few times, until the indicators above is in the right condition.

Rewind/Unload: press in offline status to rewind the tape and unload it from the tape path.

Reset: press to generate a reset on the unit. It stops all operations and tape motions, and resets the online status.

Load Rewind:

- If the tape is not loaded, press this button to load the tape and position it at the BOT-mark.
- If the tape is loaded, press this button to rewind it to the BOT-mark.

On Line: press to set the unit to Online status. It disables the Rew/Unld and Load Rew keys.

THE OPERATOR PANEL

The operator panel is divided into four parts:

- the status indicators
- the operator touch-buttons
- the display
- the diagnostic keypad (used only by ND service personnel)

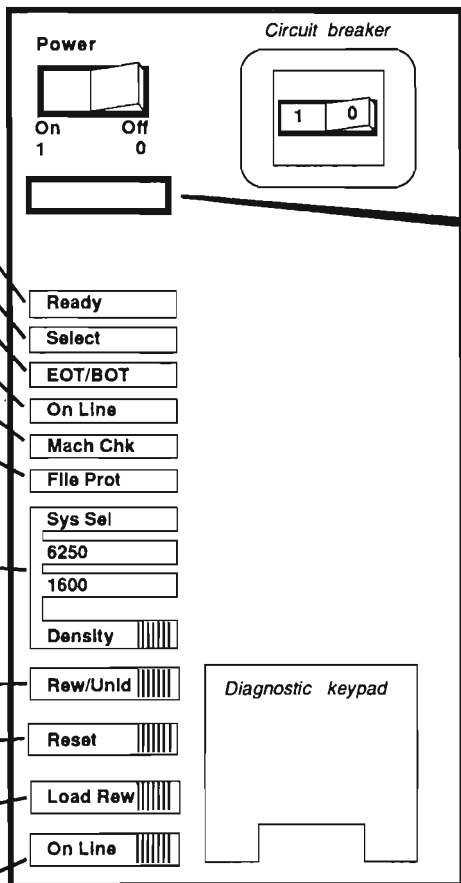

THE DISPLAY

Display conditions:

--	--	--	--

Online

-	-	-	-
---	---	---	---

Offline, test successfully completed

@	n		
---	---	--	--

Executing maintenance routine.

@	n	n	
---	---	---	--

Executing test.

		n	n
--	--	---	---

Displaying data

n	n	n	n
---	---	---	---

Displaying address

		?	?
--	--	---	---

Request for data or test ID Input

?	?	?	?
---	---	---	---

Request for address input.

	n	n	n
--	---	---	---

Fault code

DEFINITIONS

- IPS:** Inches Per Second.
- BOT:** Beginning Of Tape mark.
- EOT:** End Of Tape mark.
- BPI:** Bits Per Inch (1600 or 6250 BPI):
the density of the written data on the tape.
- Write protect:** When a tape is write protected, it is not possible to write to the tape.

This is the write enable ring.
Remove it to switch on the write protection.

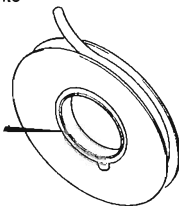

OPERATOR-HANDLED ERRORS

CAUTION !

The table below contains all the errors that can be handled by you. If any other error occurs, contact ND service personnel.

FAULT CODE	FAULT DESCRIPTIONS	ACTION
001/011 021/031 0E1	Drive not loaded before motion request.	Load tape before any motion.
002/003 022/023 032/033 0E3/0E4 0F3/0F4	BOT or EOT status detected before/during motion set.	Illegal command executed either on BOT or EOT.
0E2	Maintenance write will not run on file protected tape.	Do not use a file protected tape.